

PONDMASTER[®]

SUBMERSIBLE UV CLARIFIER

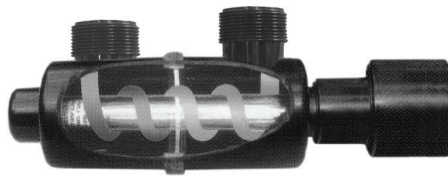

SAVE THESE
INSTRUCTIONS

10 Watt Item # 02910
20 Watt Item # 02920
20 Watt Item # 02925
40 Watt Item # 02940

CARE AND OPERATING INSTRUCTIONS

Thank you for purchasing the PONDMASTER ULTRAVIOLET CLARIFIER. This device emits ultraviolet light. String algae, which clings to the sides of ponds, does not travel through the filter and therefore is not exposed to UV rays. Barley is a natural inhibitor of string algae.

The quartz sleeve and UV lamp are not installed and are located in separate boxes inside the main box. To install the sleeve, insert the round end into the main body until the rubber bushing is all the way down into main body. A flange will prevent the bushing from going any further. It will rest against the main body. (See Photo # 1)

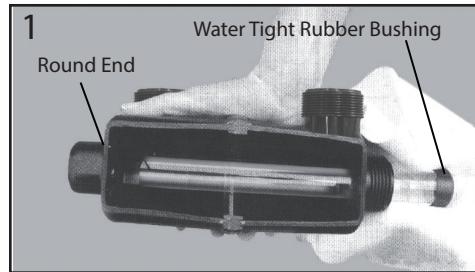

To install the lamp, unscrew the ballast from the main body. Align the center slot and pins with the mating connector that is inside the ballast. Push the lamp in firmly. Slide the lamp and ballast into the quartz sleeve and screw the ballast onto the main body. Do not over-tighten! Hand tighten until snug. (See Photos 2, 3 & 4)

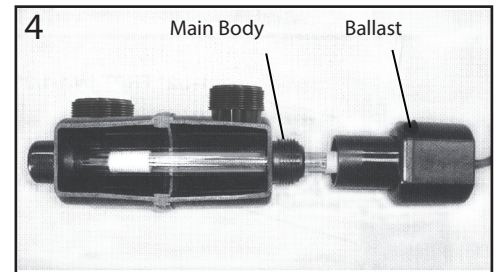
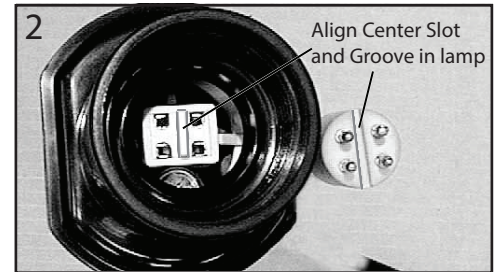
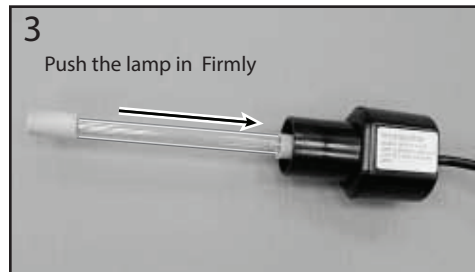

 **Warning:** Avoid exposure to direct or strongly reflected ultraviolet rays. Ultraviolet rays are harmful to the eyes and skin. ALWAYS TURN OFF POWER BEFORE HANDLING OR SERVICING THE UNIT. NEVER LOOK AT THE LAMP RAYS.

The Halo Rings on the assembled UV clarifier transmit visible light only, filtering out the UV light so they are safe to look at. This indicates that the lamp is working. Please note that the lamp will still produce visible light long after it has stopped producing UV light.

WARNING: This unit is for seasonal use only. It should not be used in freezing conditions because the quartz tube will crack, exposing live electrical current to the water. If the unit is dropped, do not use it. Unplug it first and inspect the quartz sleeve for breakage or small cracks.

WARNING! POND ARE DANGEROUS TO SMALL CHILDREN!
NEVER LEAVE CHILDREN UNSUPERVISED NEAR A POND.



ELECTRICAL PRECAUTIONS

Always use a properly grounded outlet. Do not immerse the plug in water. DO NOT REACH INTO THE WATER TO REMOVE THE PLUG. TURN OFF CIRCUIT FIRST. A "drip loop" in the cords should be used. A "drip loop" is a loop in the cord below the level of the receptacle or plug that prevents water from traveling along the cord. The national Electric Code requires that a ground fault interrupter circuit (GFCI) be installed in every branch circuit supplying the fountain or pond equipment. Your dealer can supply GFCI units. NEVER REMOVE GROUND PIN FROM PLUG.

WARNING: FOR YOUR PROTECTION, ALWAYS UNPLUG THE UNIT FROM ITS POWER SOURCE BEFORE INSTALLING OR SERVICING. SHOULD THE HALO RINGS INDICATE THAT THE UNIT IS NOT WORKING, DO NOT REACH, REMOVE OR DISASSEMBLE BEFORE YOU DISCONNECT POWER.

GENERAL INFORMATION All materials used are rugged, UV resistant and suitable for outdoor use.

For best results, the total amount of water in the pond should pass through the ultraviolet light no less than once every three hours Pumping water too fast will shorten "dwell time" - the time that the water in the unit is exposed to the ultraviolet rays. The Pondmaster Ultraviolet Clarifier can be used outside the pond when connected with tubing.

The lamp has a life of 9000 hours before the UV output drops below a useful level. It should remain on for 24 hours per day throughout the season. For best possible performance, it is recommended that the lamp be replaced every year. Remember, the lamp will produce visible light long after it has stopped producing UV wavelength.

The quartz sleeve should be cleaned periodically of dirt and lime scale build-up since it will block the UV light and reduce efficiency. Clean quartz sleeve with Pump Guard™ and non abrasive pad. See chart below or DANNER website for available sizes. Please dispose of lamp in accordance with hazardous waste laws since it contains mercury.



LAMP CONTAINS MERCURY
 Manage in accord with
 Disposal Laws,
 See: www.lamprecycle.org

NOTE: UV Clarifier's include a micro switch as a safety feature that will disable power to the lamp when opened. To test the lamp, always have ballast attached to housing with quartz sleeve installed. Do not over-tighten.

ULTRAVIOLET LIGHTING REPLACEMENT PARTS					
Model (ITEM #)	Output (Watts)	Replacement Lamp (ITEM #)	Replacement Quartz Sleeve with Bushing (ITEM#)	Replacement Ballast (ITEM #)	Replacement Bushing only (ITEM #)
02910	10	12971	12981	12991	12985
02920	20	12972	12982	12992	12985
02925					
02940	40	12974	12984	12996	12985

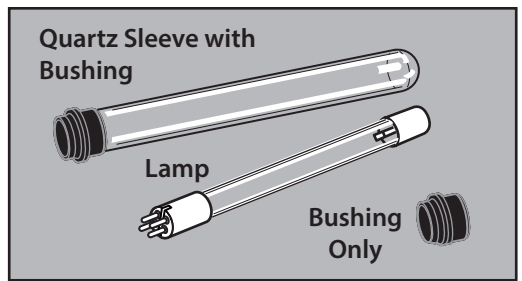

NOTE: Use only genuine Pondmaster replacement Lamp and Quartz Sleeve. Always check the ITEM Numbers to assure that your are using the correct wattage Lamp and the correct Quartz Sleeve.

PUMP GUARD™ MAINTENANCE SOLUTION			
SIZE	4 OZ	32 OZ	1 GALLON
ITEM #	03905	03907	03909

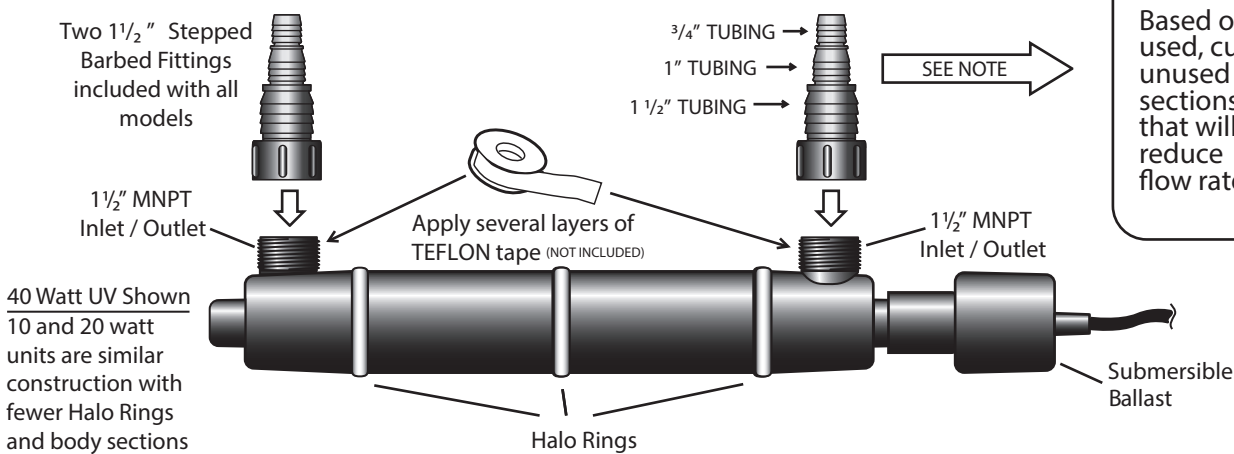

Maximize Flow

Based on tubing size used, cut off any unused sections that will reduce flow rate.



LIMITED WARRANTY
 E.G. Danner Mfg. Inc will repair or replace any unit found to be defective within one year of original purchase. Cutting or altering cord voids any warranty consideration. For warranty repair return only the part that is defective to our factory. Please include a dated proof of purchase and \$10.00 for postage and handling. Damages or injuries resulting from negligence or misuse of product are not covered by warranty. This warranty gives you specific legal rights. You may have other rights which vary from state to state.

Danner Mfg. Inc., Islandia, New York 11749-1489 - (631) 234-5261 - Visit our website www.dannermfg.com